



XLR

THUNDERBOLT

FIFTH WHEEL TOYHAULERS



XTENDED LIVING AND RECREATION



422 AMP Kick back and relax! This NEW side deck floorplan has it all! Cool blue LED lighting accents the LG countertop's translucent edge. Cozy up by the modern, electric fireplace with glass rocks and an energy efficient infrared heating system. Enjoy movies or your favorite sporting event on the large LED TV, with a sound system that puts you in the middle of the action. This plush, four seat, Zero wall-hugging recliner sofa has integrated lumbar support, and is the most comfortable seating in the industry. Blue LEDs highlight the heat/massage control cup holders and the sofa base.



422 AMP *The 422 AMP features a side patio deck with an electric fireplace, an LED TV and two entry doors (one to the garage, and the second to the living space). The off door side entrance with stow-and-go steps offers convenient access to the fuel station and your toys.*



Bold, Luxurious and Loaded for True Multi-Purpose Living!

Choose your destination, load up your friends, all your gear and hit the road! Head turning Thunderbolt fifth wheels are the best toy haulers on the market today. Outstanding details include rich, Espresso cabinetry and wainscoting, elegant frosted glass cabinet doors, plus LG solid surface countertops and recessed stove tops. All Thunderbolts are furnished with an XLR King bed and LED lighted recliners, and are accented with dramatic blue LED lighting throughout. Garage and outdoor patio configurations maximize versatility and extend living space. They're designed to fit today's most popular side-by-sides, four wheelers, motorcycles, grills, kayaks, bicycles, pets and kids.



422 AMP *Thunderbolts are reknown for modern design and ergonomic floorplans. Stock up for a long adventure and cook up a storm! This well-planned kitchen has plenty of storage and prep space, plus stainless steel, deep bowl sinks with a contemporary faucet.*





XLR
THUNDERBOLT
FIFTH WHEEL TOYHAULERS

413 AMP Gather around for good times! This open, inviting living space features a large LED TV, fireplace and Sony touch-screen Bluetooth DVD player. Contemporary blue LED lights compliment the rich Espresso wood interior. Durable Birchwood plank-style Beauflor® flooring contrasts with the bold decor. Solid wood treaded steps add safety. There's a modern ceiling fixture, residential microwave, a recessed stove top with front high output burner and a 22" oven, plus a large 12 cu. ft. 4-door gas/electric RV refrigerator – all standard! For added convenience, the optional "MyRV" multiplex system controls lights, awning, slide outs, and the leveling system from a touch screen or smart phone. An 18 cu. ft. stainless steel 110V residential refrigerator is also available as an option.



413 AMP *This spacious contemporary bathroom features a 40" shower with convenient seat, skylight and a glass door.*



Go Big. Go Bold. Go XLR!

Outdoor enthusiasts, family vacations, sporting events or off-road adventures...the possibilities are endless. Even better, Thunderbolt's flexibility offers years of luxury living as your interests evolve and change.



413 AMP *This spacious XLR king bed master suite offers plenty of his and hers mirrored wardrobe space, night stands and reading lights for a residential touch. There's even a USB charger for your smart phone or tablet! Shown in Onyx decor.*

This Versatile Living Space Rocks!

Now guests and kids have it all in the 413 AMP's garage/bedroom/living space. This full second bathroom is easily accessed via the garage or the patio deck, reducing tracking the outdoors - indoors. Both washer/dryer prep and a Dyson vacuum are standard.

XLR THUNDERBOLT

FIFTH WHEEL TOYHAULERS

CONSTRUCTION

1. Two-tone Painted Gel Coat
Fiberglass Radius Cap
2. Molded Hitch Pin Cover
3. Radiant Foil Insulation R38 at 80°F
4. 7,000 lb. E-Z Lube® Dexter® Axles
5. 16" Radial Tires (G-rated is optional)
6. Nitro Filled Tires (Includes one year, no excuses warranty)
7. 5/8" Plywood Floor Decking
8. Fully Enclosed/Heated Underbelly
9. Holding Tanks Secured by Frame Cradle
10. 3" Wood Floor Joists with Fiberglass Insulation
11. Slam Latch Compartment Doors
12. Ultra View Frameless Windows
13. High Gloss Fiberglass Exterior
14. Laminated and Insulated Slideout End Walls/Roof
15. Beavertail Storage Compartment
16. 1" Garage Floor Decking with Rubberized Flooring
17. 8 Ft. Easy Lift, 3,000 lb. Ramp Door
18. One Piece Super Flex Roofing with 12 Year Materials Warranty
19. 15,000 BTU Air Conditioner
20. 6-Point Hydraulic Level-up System
21. Steel Anchor Plates for 5,000 lb. Tie Downs
22. High Efficiency A/C Duct System
23. Vacuum Bonded Sidewall with Block Foam Insulation
24. 3/8" Roof Decking
25. Fiberglass Roof Insulation
26. Radius Metal Roof Transition
27. Attic Vents
28. 102" Widebody Construction
29. Full Walk On Roof
30. 2" Aluminum Framed Sidewalls
31. Hydraulic Wide Stance Front Landing Gear



Collapsible ladder stores flat and is ready when you need it. The NEW Zero Gravity rear door has a hidden hinge system for a clean look.



TURN HEADS

AMP it up! XLR Thunderbolt offers six of the hottest full body paint schemes on the road, or in the campground.

Standard Intensity Graphics Package - Aztec Grey with two-tone painted cap



Full Body Paint - Black Pearl



Full Body Paint - Acid Green



Full Body Paint - Victory Red



Full Body Paint - Neon Yellow



Full Body Paint - Cobalt Blue



Full Body Paint - HD Orange

STANDARDS AND OPTIONS



MaxxAir Power roof vent in bathroom



Rear vision observation camera



Optional keyless entry



Keyed Alike - single key lock system



Washer/dryer prep



Deep bowl sink with pull-out faucet and solid surface countertop with LED accent lighting



Optional energy management system with three ACs efficiently manages usage



Neo-blue exterior marine grade speakers



Optional JBL premium sound system



Tankless water heater control



110V Residential refrigerator



Zero Gravity reclining chairs are included with the VIP patio deck



"Maintenance Free", LED lit Tread Lite aluminum steps, with four steps at the front and three steps at the rear entrances.



Pantry storage



Standard convenience center keeps all your utilities in one place



Optional Multiplex system controls lighting, dimmers, awnings, slides, tank levels, generator, energy management and is ready for wireless smart phone apps.



Beavertail storage bin



Heavy-duty 5,000 lb. steel reinforced tie-down system secures cargo.



Frameless tinted safety glass windows



Sony subwoofer



Touch screen stereo



Glass cabinet doors with hidden hinges



MORryde CRE suspension enhancement system



Waste Master RV sewer management system (N/A on the 340AMP and 341AMP)



Convenient pop-up charging station



Black out roller shades



Three-season patio door provides easy in and out access to the rear VIP deck. Removable panels over the screen doors keep dust and sand out.



XLR THUNDERBOLT

FIFTH WHEEL TOYHAULERS



MORryde Zero G Ramp Door and VIP Deck with Electric Awning



Pack for a party!

Hit the optional VIP Patio deck equipped with two Zero Gravity chairs. The stow away rail system, with easy to use attachment clips, packs away easily when it's time to head out. Shown with these additional options: electric awning, access steps and a three-season patio door that swings out over the ramp, to make loading and unloading a breeze.



FIFTH WHEEL TOY HAULERS

Whether you're off for an extended adventure or you're a weekend warrior, XLR Thunderbolt Fifth Wheels have the comfort, convenience and the right floorplan configurations to hold all your gear in major style.

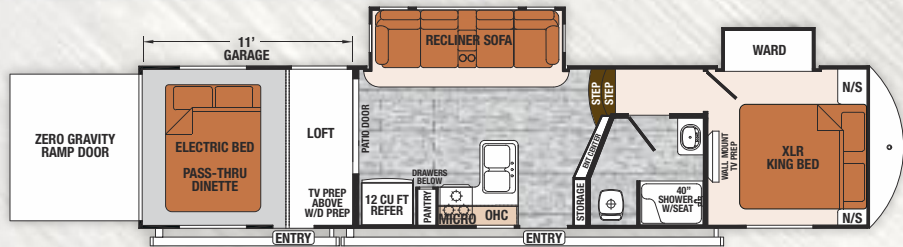

340AMP

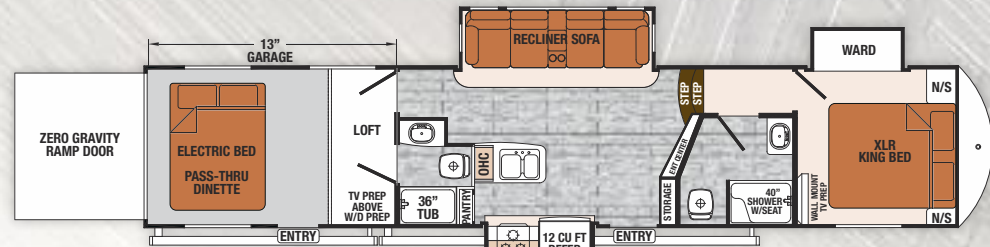

413AMP

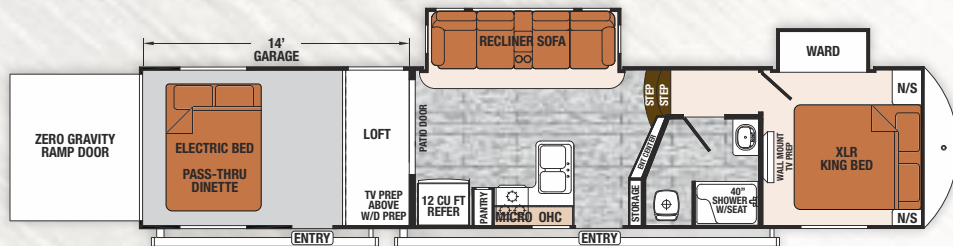

341AMP

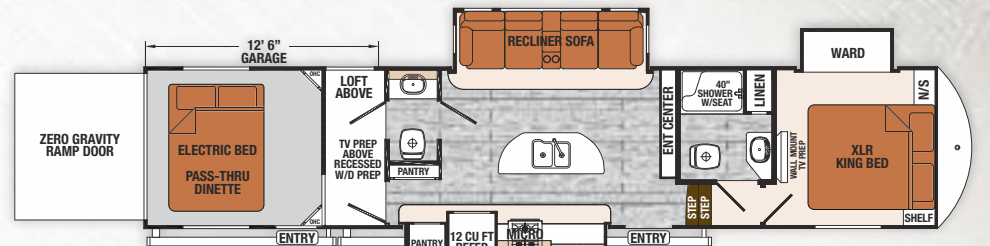

415AMP

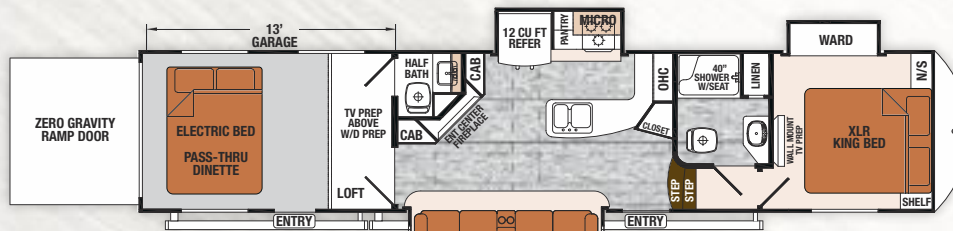

375AMP

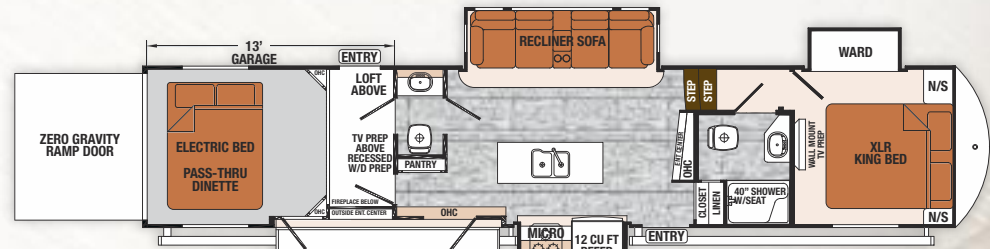

422AMP

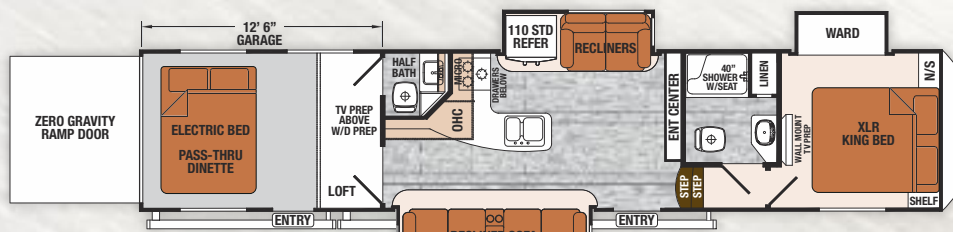

380AMP

DÉCOR

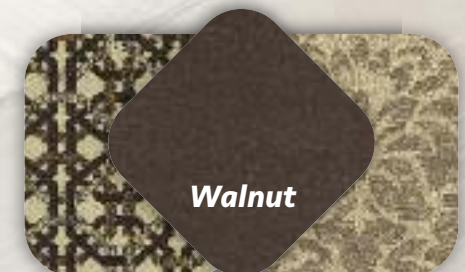

STANDARDS AND OPTIONS

INTERIOR DECOR

- Onyx
- Walnut

EXTERIOR STANDARDS

- Aluminum Framed Laminated Sidewalls
- 102" Wide Body Construction
- Powder Coated Steel I-Beam Chassis
- Large Entry Door Assist Grab Handles
- Marine Grade Speakers with LED Lights
- Ultra View Frameless Windows
- 21K Hitch Pin
- Hydraulic Front Landing Gear
- Molded Fiberglass Hitch Pin Cover
- Dual 30# LP Tanks
- Collapsible Exterior Ladder
- Electric Awning with LED Strip Light
- Heated and Enclosed Underbelly
- Utilities Convenience Center
- Reverse Activated Rear Flood Lights
- Gen Prep with 18 Gallon Fuel Tank
- Attic Ventilation System

INTERIOR STANDARDS

- LED Interior Lighting
- Tongue and Groove Plywood Decking
- Beauflor® Birchwood Plank Flooring
- Shaker Style Cabinetry
- Stainless Steel Deep Double Bowl Sink
- Large LCD Living Room TV
- 42K BTU Furnace

- Insulated Garage Floor
- 12 Cu. Ft. Refrigerator (Most models)
- Hid-N-Screen
- Porcelain Foot Flush Toilet
- Washer/Dryer Prep in Rear Area
- 5,000# Steel Reinforced Tie Downs
- 15K BTU Ducted A/C
- 100 AMP Converter
- Crown Molding - All Rooms
- Upgraded Bed Board Accents
- Flush Floor Living Room Slideouts
- Residential Shower with Seat

2017 LIGHTNING PACKAGE

- Front Cap LED Strip Lighting
- 7,000# Dexter® Axles
- 7' 6" Main Slide Height
- Wide Stance Frame Upgrade
- Spare Tire
- Stainless Steel Appliances
- Residential Kitchen Faucet
- Satellite Prep
- Dyson Cordless Vacuum
- Pillow Top Residential Mattress
- Solar Charger Input
- Friction Hinge Door
- Roller Shades (Bedroom, Living Room)
- Radiant Roof/Floor/Slide Out Floor/Front Insulation (R-38 @ 80°F)
- 6-Point Hydraulic Auto Level System

2017 ACCELERATOR PACKAGE

- LED Lighted Countertops in Galley
- Alumi-Tread Entry Steps
- Rear Vision Observation Camera
- Keyed Alike - Single Key Lock System
- MORryde Zero G Ramp Door and VIP Deck with Electric Awning
- MORryde CRE Suspension Enhancement
- Waste Master RV Sewer Management System (N/A on 340AMP and 341AMP)
- MaxxAir Powered Roof Vent (Bathroom)
- Neo Blue LED Marine Grade Exterior Speakers

CUSTOM EXTERIOR PACKAGES

- Intensity Package (Two-tone, Gel Coat Painted Cap, Aztec Grey Sidewalls, Upgraded Graphics)
- Full Body Paint with Premium Gel Coat Sidewalls: Black Pearl, Freedom Blue, HD Orange, Victory Red, Acid Green, Neon Yellow

MANDATORY EQUIPMENT

- 5.5kW Onan CARB EVAP Generator
- Electric Bed with Max Clearance Pass Thru Dinette
- Mobile Fuel Station with Fuel Tank

OPTIONAL EQUIPMENT

- Extreme Weather Package (Dual Pane Windows, 12V Heated Tanks)

- Second Electric Awning (FW)
- 12V - 160 Watt Solar Kit (Add Up to 3 Panels)
- Multi-Function Wireless Remote System (N/A with Multiplex)
- Keyless Main Entry Door
- 32" Flat Screen TV (Bedroom, Garage, Patio – 422AMP)
- JBL Premium Sound System
- Satellite Wiring Pkg
- myRV® Multiplex System
- 110V Residential Refrigerator Upgrade with Inverter
- Convection Microwave
- Second Air Conditioner
- Three High Efficiency A/Cs with Energy Management System
- MaxxAir Power Roof Vent
- Girard Tankless Water Heater IPO Standard Water Heater
- 3 Seasons Door IPO Hid-N-Screen
- Euro Chair - Single
- Plush Removable Cargo Carpet
- VIP Patio Steps
- G-Rated 14 Ply Radial Tires
- Sway Command™ Sway Control

MODEL	340AMP	341AMP	375AMP	380AMP	413AMP	415AMP	422AMP
Hitch Weight	2636	2725	3595	2881	3323	3023	3643
UVW	12698	13903	15297	15361	16280	15764	16364
Cargo Capacity	3938	2822	5703	5639	4720	5236	4636
Exterior Length	40' 4"	43' 0"	44' 2"	44' 3"	44' 6"	44' 3"	44' 6"
Exterior Height	13' 4"	13' 4"	13' 4"	13' 4"	13' 4"	13' 4"	13' 4"
Exterior Width	102"	102"	102"	102"	102"	102"	102"
Fresh Water (gal.)	108	94	154	154	158	154	158
Grey Water (gal.)	60	80	82	100	110	100	80
Black Water (gal.)	30	50	100	50	80	95	100

GVWR (Gross Vehicle Weight Rating) - is the maximum permissible weight of the unit when fully loaded. It includes all weights, inclusive of all fluids, cargo, optional equipment and accessories. For safety and product performance do NOT exceed the GVWR.

GAWR (Gross Axle Weight Rating) - is the maximum permissible weight, including cargo, fluids, optional equipment and accessories that can be safely supported by a combination of all axles.

UVW (Unloaded Vehicle Weight)* - is the typical weight of the unit as manufactured at the factory. It includes all weight at the unit's axle(s) and tongue or pin and LP Gas. The UVW does not include cargo, fresh potable water, additional optional equipment or dealer installed accessories.

CCC (Cargo Carrying Capacity)** - is the amount of weight available for fresh potable water, cargo, additional optional equipment and accessories. CCC is equal to GVWR minus UVW. Available CCC should accommodate fresh potable water (8.3 lbs. per gallon). Before filling the fresh water tank, empty the black and gray tanks to provide for more cargo capacity.

*Estimated Average based on standard build optional equipment.

**Estimated average based on standard build optional equipment.

Each Forest River RV is weighed at the manufacturing facility prior to shipping. A label identifying the unloaded vehicle weight of the actual unit and the cargo carrying capacity is applied to every Forest River RV prior to leaving our facilities. The load capacity of your unit is designated by weight, not by volume, so you cannot necessarily use all available space when loading your unit.



XLR THUNDERBOLT FIFTH WHEEL TOYHAULERS



**Play hard
and rest
easy with
Thunderbolt!**

Thunderbolt Toyhaulers maximize versatility. This max clearance dinette flips down for a full 8' of space when loading your toys, plus there's an electric bed above. It's more than an garage, with textured, gas and oil resistant industrial flooring, designed to transport today's most popular side-by-sides, 4-wheelers, motorcycles, grills, kayaks, bicycles, pets, and kids. It's also a dining room, a game room/recreation area, or a private second bedroom with a dedicated bathroom, (select models). An optional roll-out carpet amps up the comfort.

XLR Thunderbolt by Forest River

2421 Century Drive ■ Goshen, IN 46528
E-mail: XLRinfo@forestriverinc.com
Phone: 574-642-0438 ■ www.forestriverinc.com/XLR
www.forestriveraccessories.com ■ [#XLRtoyhaulers](https://twitter.com/XLRtoyhaulers)



XLR Thunderbolt Owner "Digital Kit" App

Now you can have your Owner's Manual with you wherever you are. Download our FREE App from the App Store or Google Play and you'll have the information right at your fingertips.



Find us on Facebook

FREE MEMBERSHIP
to Forest River Owners' Group

www.forestriverfrog.com



Actual towing capacity is dependent on your particular loading and towing circumstances, which includes GVWR, GAWR and GCWR, as well as adequate trailer brakes. Please refer to the Owners Manual of your vehicle for further information. All information contained in this brochure is believed to be accurate at the time of publication. However, during the model year, it may be necessary to make revisions and Forest River, Inc., reserves the right to make all such changes without notice, including prices, colors, materials, equipment and specifications as well as the addition of new models and the discontinuance of models shown in this brochure. Therefore, please consult with your Forest River dealer and confirm the existence of any materials, design or specifications that are material to your purchase decision. ©2016 XLR, a Division of Forest River, Inc., a Berkshire Hathaway company. All Rights Reserved. 12/16



PRE-DELIVERY INSPECTION FACILITY

20,000 square feet of quality assurance. The bare essentials for a premium product. This state-of-the-art facility gives immediate daily feedback to production for quality assurance in every unit built.

24/7 EMERGENCY ROADSIDE ASSISTANCE

For a worry-free ownership experience Forest River includes one year of Coach-Net RV Technical & Roadside Assistance with each RV purchase. Whether new to the RV lifestyle or an experienced RV enthusiast, Forest River owners have 24/7 access to technical, operational and emergency road service coverage throughout the US & Canada. Coach-Net's fast, dependable service is just a phone call away.

Coach-Net[®]
RV Technical & Roadside Assistance



Learn More

Scan this barcode using a QR Reader on your smart phone to learn more about Forest River.



A Berkshire Hathaway company.

CUSTOMER SATISFACTION



www.ForestRiverBuyLocal.com

Your XLR Thunderbolt Dealer